

“Doll Dress”



What little girl wouldn't love to dress her 18" doll in this outfit? MasterWorks Lite will be the tool used to complete this project along with your sewing and embroidery machine. This is the second project of a series of three. The final project in this group will be posted next month. The skill level on the projects will increase as your knowledge of the program grows.

Skill Level: Intermediate

Created by: Diane Kron, Software and Embroidery Project Manager

Supplies:

Baby Lock® sewing and embroidery machine

MasterWorks Lite from Designer's Gallery®

18" Doll

Simplicity Pattern #4347 for 18" doll clothes or similar pattern

Dotted Swiss fabric, yardage per pattern

Baby Lock® Tear-Away stabilizer

Temporary spray adhesive

Madeira sewing and embroidery thread



Water erasable marking pen

General sewing and embroidery supplies

Instructions

At the Computer:



1. Open the program by clicking on the MasterWorks Lite icon on the desktop.
2. To place the hoop on the workspace, click on menu View and click on Select Hoop. Select the 200mm x 300mm hoop. Click OK. **Note:** *If you are using a machine with a smaller hoop, adjust the size of the design so that it fits in your hoop.*
3. Click on the Grid  icon to place the grid on the workspace.
4. To activate tool to draw the shape, click on the down arrow next to the Rectangle tool  on the left toolbar. Select the Triangle  tool from the fly out.
5. Left click and drag a small triangle anywhere on the workspace. To place the shape on the workspace, release your finger from the mouse. The image shown below has been zoomed in on to show the drawn shape. (From now on, whenever we work with any portion of the artwork or design it will need to be selected.)

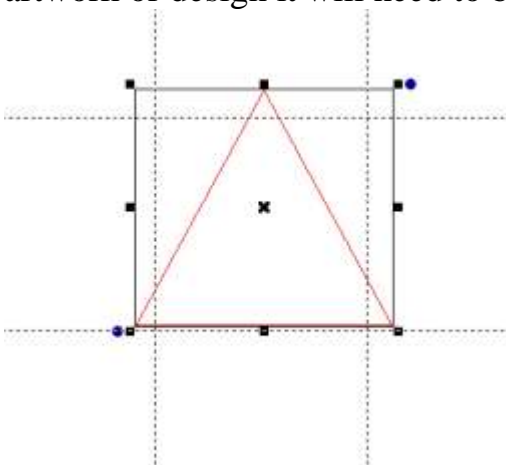

6. To set the exact size on the shape, click on Transform in the Properties field.

- Remove the checkmark from Maintain Aspect Ratio.
- In the Width field type in 13mm.
- In the Height field type in 15mm.
- Click on Apply.

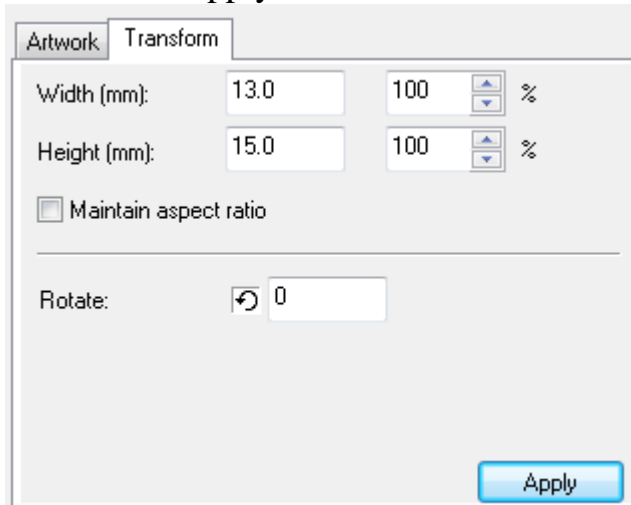

7. Left click and move the artwork to the top center, within the hoop.

8. To apply the motif to the artwork:

- Click on the Run Motif  icon on the bottom toolbar.
- In the Properties field click on the down arrow next to Motif and choose the Motif named f016. (*See the illustration below.*)

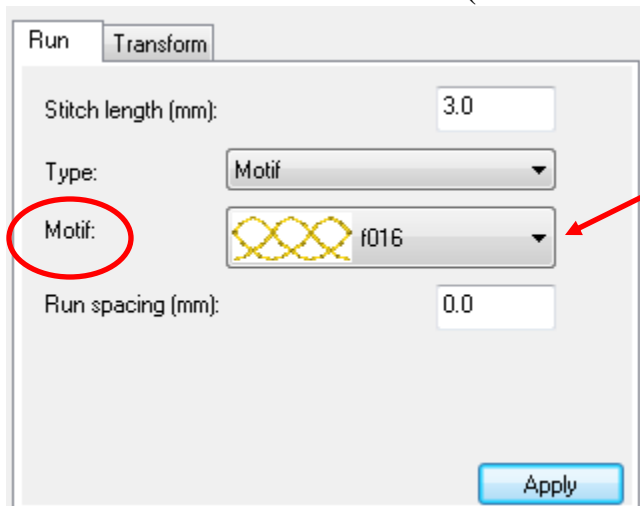

- Click Apply. (*The design will look like the following illustration.*)

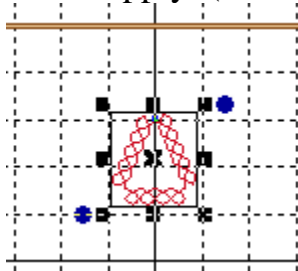

9. With the design selected, right click on the workspace and choose Copy from the list of commands. Right click again and choose Paste to duplicate the design.

10. The duplicated design will be selected. Click on Flip Vertical .

11. Left click on the flipped design and move below the first design. Place both designs on the center Solid Major Grid Line (as shown in the following illustration). If you need to fine tune the placement of either of the designs, click on the up or down arrows while holding down the Ctrl key on the keyboard to move the designs. The designs should touch slightly.

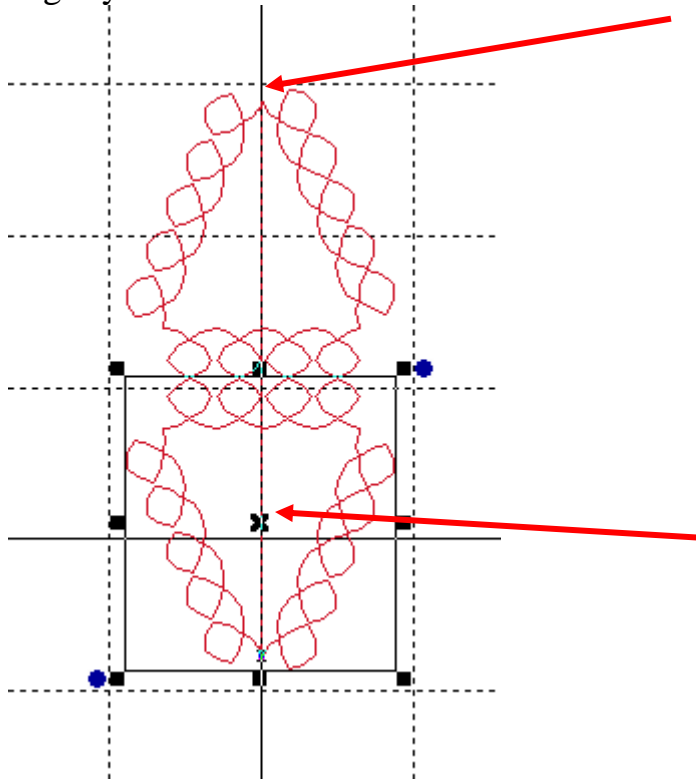

12. To select both segments of the design, click on All Items under the Sequence View field.

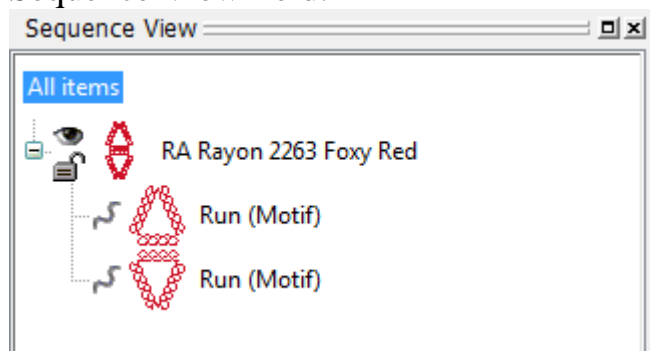

13. Right click anywhere on the workspace and from the list of commands click on Group. Now when you click on either segment both segments will be selected as one segment.

14. Right click again on the workspace and choose Copy from the list. Right click again and choose Paste to duplicate the segments.

15. Move the duplicated segments below the first again making sure that the segments slightly touch and are positioned on the Solid Major Grid Line. (See the illustration below.)

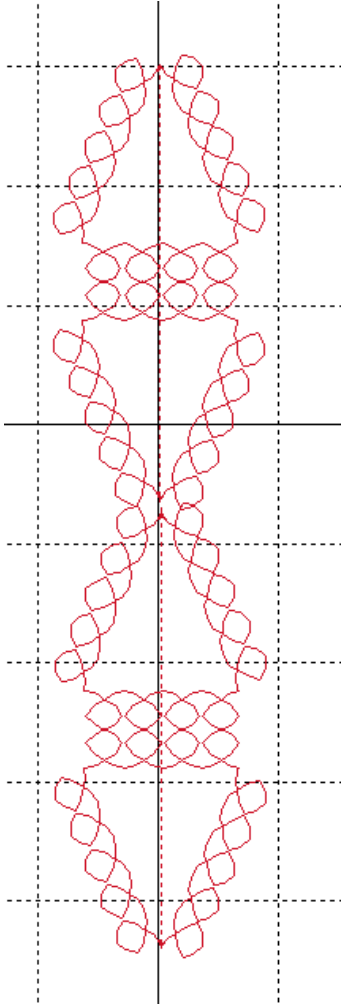

16. Repeat Steps 14 and 15 until the hoop has 7 sets of two segments. (If you have a machine that requires the use of a smaller hoop place fewer sets together to fit in the largest hoop for your machine. It will also require more hoopings to finish the project.)
17. To be sure that all of the segments are centered, select all Items under Sequence View; click on the down arrow next to the Center tool  and select Horizontal Center Align.
18. Click on All Items under the Sequence View and change the color on all the lines to blue.
- Click on the down arrow next to the Color Palette and select Madeira Rayon thread. Select the thread color (shown in the illustration below). The color change is automatically applied.

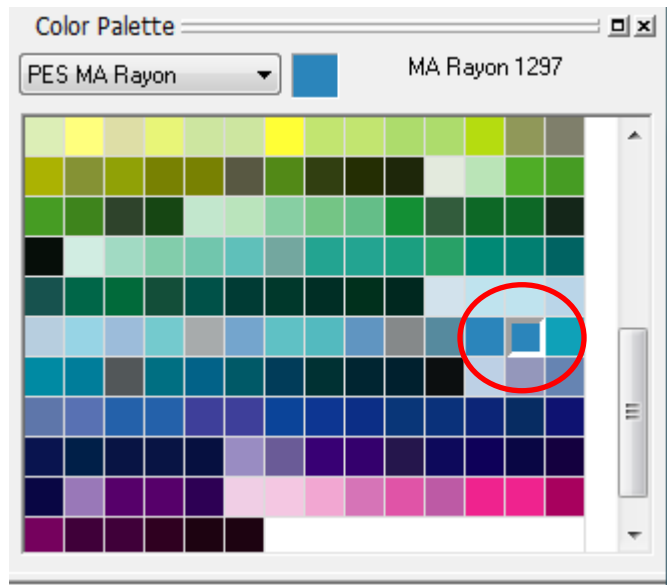

19. Click on Print Preview  and follow the prompts to print out two copies of the template. To be sure that the design will print at 100%, click on Settings and place a checkmark in Print Actual Size field (*as shown in the illustration below*). Click on Ok.

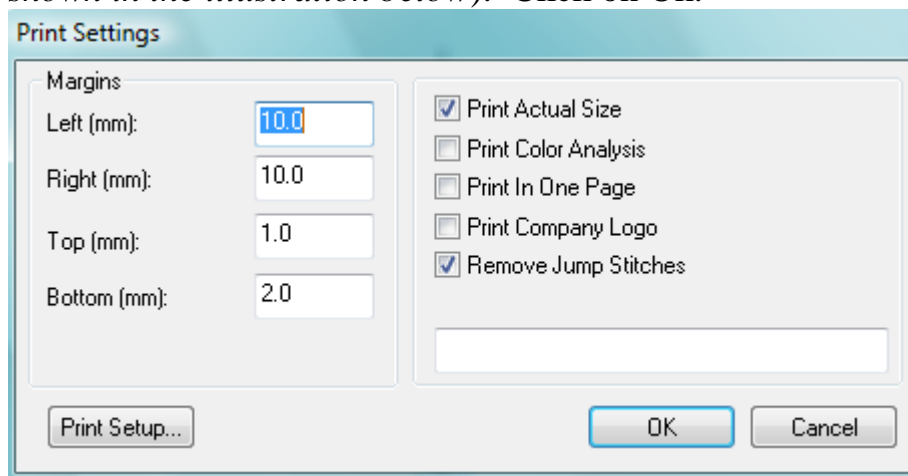

20. Click on File Save As and save as a Working File format (.blf). Then, save as a .pes file to the media device that your embroidery machine will read.

At the Cutting Table:

1. Cut out the pieces for the skirt and the blouse from the Dotted Swiss fabric.
2. Determine the placement of the design on the skirt. Draw a straight line using a water erasable marker to mark the area across the bottom edge of the skirt. The design was placed ½" above the hem line.

At the Embroidery Machine:

1. Hoop the stabilizer and spray with the temporary spray adhesive.

2. Place the fabric in the hoop and finger press smooth. In the sample, the design is placed at the bottom edge of the skirt to create a border design.
3. Merge the design onto the embroidery machine's workspace. Merge another copy of the design onto the workspace and move the design approximately 1/2" above the first design. Embroider the design using the Madeira blue thread or use any other thread color to complete the look.
4. Hoop another piece of stabilizer and spray with the temporary spray adhesive.
5. Pin the templates next to the first embroidered design. Line up the templates so that they touch the embroidered section horizontally. Take your time with this so that you have perfect alignment.
6. Once you have determined the placement, finger press the templated fabric onto the hoop. Use the cross marks on the template and the marks on the hoop for accurate placement. Repeat until the skirt border has been completely embroidered.
7. Place one row of embroider on each of the straps for the skirt and follow the same directions above if you need to re-hoop.

At the Sewing Machine:

1. Assemble the outfit following the directions from the pattern.

For other exciting projects like this one, visit our Web site at

www.designersgallerysoftware.com



Your Email Could Use A Little Embroider-E

Subscribe to the only embroider e-news devoted to embroidery software today :-



Designer's Gallery
Lets Embroidery Designs Work For You