

“QuiltWorks II – Irish Chain Quilt”



Here is a project that will bring out the Irish in all of you. By using a classic Irish chain quilt pattern and QuiltWorks II from Designer's Gallery, you can create a quilt that will be the envy of old and young alike.

Skill Level: Intermediate

Created by: Diane Kron, Software and Embroidery Project Manager

Supplies:

Baby Lock® sewing and embroidery machine

QuiltWorks II from Designer's Gallery®

3 Yards off white fabric

2 Yards of dark green print fabric

3 Yards of beige print for backing

Baby Lock Walking Foot



Invisible quilting and embroidery threads

General sewing and embroidery supplies

Finished size: 55" x 66"

Instructions

At the Computer:

1. Open the program by clicking on the QuiltWorks II  icon on the desktop.
2. To place the hoop on the workspace, click on View menu and click on Select Hoop. Select the 200mm x 200mm hoop. Click OK.
3. Click on the Grid  to place the grid on the workspace.
4. In this step we will work with a built-in line art image and convert it to stitches making a few minor adjustments to the design. Follow the next set of steps to create the design:

- Click on the Outline Wizard  tool located on the top toolbar.
- Click on Select Image.
- Open the Line Art folder where the built in images are located.
- Scroll down and select Lineart11 image and click Open.

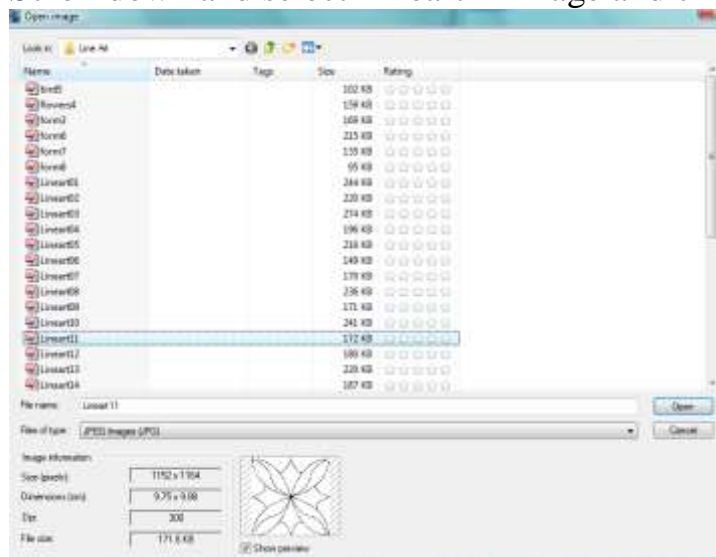

- Click on Next to continue.
- In the Image Transformation field, under Image Type select Lineart Image.
- Under Set New Image Size, change the width to 6". This is the finished size of each of the blocks in the quilt. Click on Next to continue.

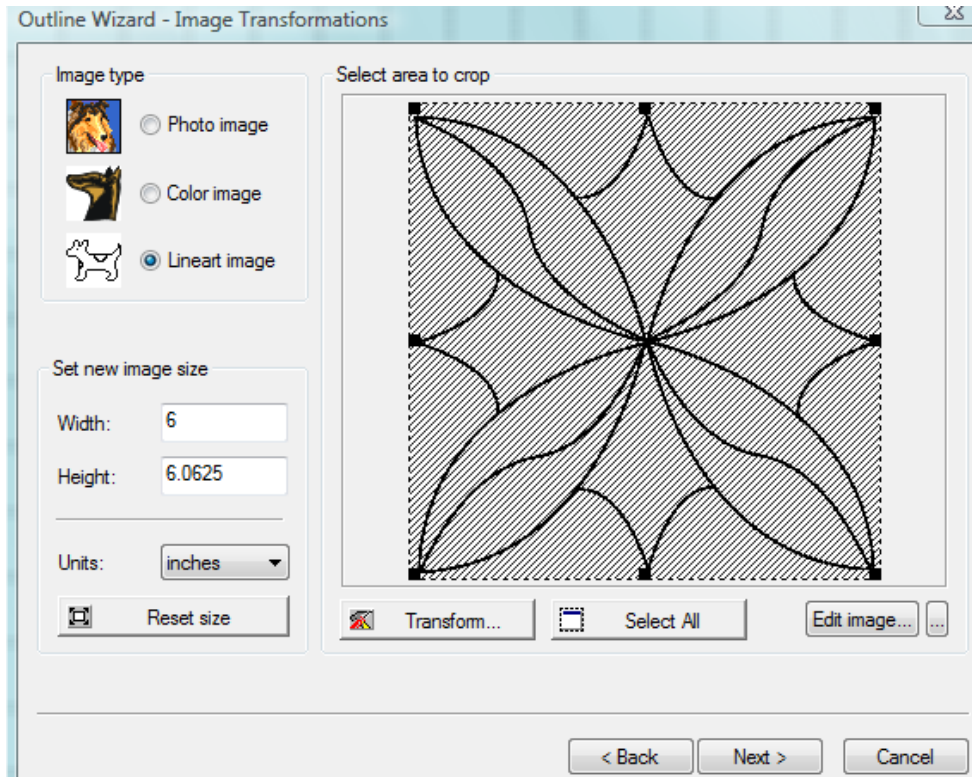

- In the Vectorize field we will do nothing, since the program read all of the lines that will be needed for the project. Click on Finish to send the design to the workspace.
 - Under Sequence View, the design will be broken down into segments. To merge the segments into one unit: click on All Items, right click on the mouse and from the list of commands choose Combine. Now there will be only one segment in the design. The embroidery machine will do one continuous path with no additional tie offs and with only one tail on the backside of the quilt. The design is complete!
5. Click on Print Preview  and follow the prompts to print out a template of the design.
 6. Click on File Save As and save as a Working File format (.blf). Give the design a name and save as a .pes file to the media device that your embroidery machine will read. Set the design aside for now.

At the Cutting Table:

From the white fabric cut the following:

1. Cut six 6 ½" wide strips. Cut the strips into 31 6 ½" squares. Set them aside.
2. Cut 23 2 ½" wide strips. These will be used for the border strips and to create the 9-patch squares.

From the Dark green fabric cut the following:

1. Cut 19 2 ½" wide strips. These strips will be used to create the nine-patch squares and for the border strips.
2. Cut six 2 ½" wide strips for the binding on the bias.

Assembly:

1. First Set:
 - Create five sets of striped sections; Using a ¼" seam allowance sew the dark green and white 2 ½" strips together starting with the dark green on the outside, white in the middle and dark green on the other side.
 - Press the seams toward the dark green strip.
 - Cut across the strip at 2 ½" intervals to create 72 sections.
2. Second Set:
 - Sew six strips using the 2 ½" starting with the white on the outside, dark green in the middle and ending with the white strip on the end.
 - Press the seams toward the dark green strip.
 - Cut across the strip at 2 ½" intervals to create 36 nine patch units.
3. To join the two sets together follow the next set of directions.
4. Sew two dark-white-dark units on both sides of one light-dark-light unit. Make 36 units.
5. To form the first row on the quilt, start with the nine patch unit. Join one of the 6 ½" white squares together. Alternate squares and end with the nine-patch square. There will be a total of seven blocks in each row.
6. For the second row, start with the white square and end with a white square while alternating with the nine-patch. Create seven rows.
7. Sew the rows together, being careful that you alternate the squares. Press the seams in the same direction.
8. Sew the remaining strips together end to end to create the strips for the borders
9. Make white-green-white strips with the long strips.
10. Even up all of the sides if needed using a rotary cutter and mat.
11. Pin and sew the side borders to the quilt top. Press toward the borders.
12. Add the nine patch blocks to both ends of the top and bottom borders matching seams. Sew to the top and bottom of the quilt.
13. Seam together the backing for the quilt using the beige fabric.

14. On a flat surface, sandwich the batting between the backing and the pieced quilt top. Spray, temporary spray adhesive to hold the layers together.
15. Use invisible thread for the top thread and bobbin thread that blends well with the backing fabric. Attach the Baby Lock walking foot to the machine and stitch in the ditch around each of the 6" blocks.
16. Bind the quilt using the 2 ½" bias strips. Sew the strips together to create one continuous bias strip. Fold the raw edges together and press.
17. Starting 6" down from a corner place the bias strip and begin to sew 2" down from the start of the bias strip. Stop when you get ¼" away from the corner. Fold the bias strip upward while keeping the bias strip and the side edge of the quilt even. Fold the bias strip down so that the bias is positioned with the raw edges even and continue to sew the bias to the quilt. Continue in this manner through each of the corners on the quilt. Your corners seams will be perfect 45° angles. Cut off the end of the bias strip leaving 1 ½" to tuck into the bias starting point. Finish by sewing the bias in place. Fold the binding to the back of the quilt and sew in place.

At the Embroidery Machine:

1. Pin the template to the center of the first white square on the quilt.
2. Using the 200mm x 200mm hoop, hoop the quilt, centering the templated area in the center of the hoop. Since this will be thick, loosen the screw for ease of hooping. **Note:** We are not using stabilizer for this project. The back will look as good as the front with no stabilizer showing or needing to be removed.
3. With the design merged onto the embroidery machine's workspace, center the needle over the cross marks on the template.
4. Remove the template from the hoop. Embroider the design using the thread color of your choice. In the sample beige thread was used.
5. Repeat these steps for each of the white quilt squares on the quilt.

Your Email Could Use A Little Embroider-E



Subscribe to the only embroider e-news devoted to embroidery software today :-)

Designer's Gallery
Lets Embroidery Designs Work For You

For other exciting projects like this one, visit our Web site at www.designersgallerysoftware.com