

“QuiltWorks II – Sweater/Jacket Makeover”



Do you have a sweater that you once loved but find it to be last year's fashion? Well here is the perfect solution! With a seam ripper and QuiltWorks II you will be on your way to creating a vest that fits right in with today's style.

Skill Level: Advanced

Created by: Diane Kron, Software and Embroidery Project Manager

Supplies:

Baby Lock® Ellisimo sewing and embroidery machine

QuiltWorks II from Designer's Gallery®

Boiled wool sweater from your closet or look in a resale shop for a similar style
(The before picture is located at the end of the project)

1 Yard of a green print cotton fabric

Baby Lock® Tear-Away stabilizer

Covered buttons to fit the buttonhole opening

Seam ripper

Temporary spray adhesive



Sewing and embroidery thread

Chalko Liner

General sewing and embroidery supplies

Instructions

At the Computer:

1. Open QuiltWorks II. 
2. Click on the Outline Wizard  and retrieve the Flower image. This image is built in the program files and listed under Color images (*as shown in the following illustration*).
3. Click on Open to continue through the Wizard. Click on Next to go to the next field.

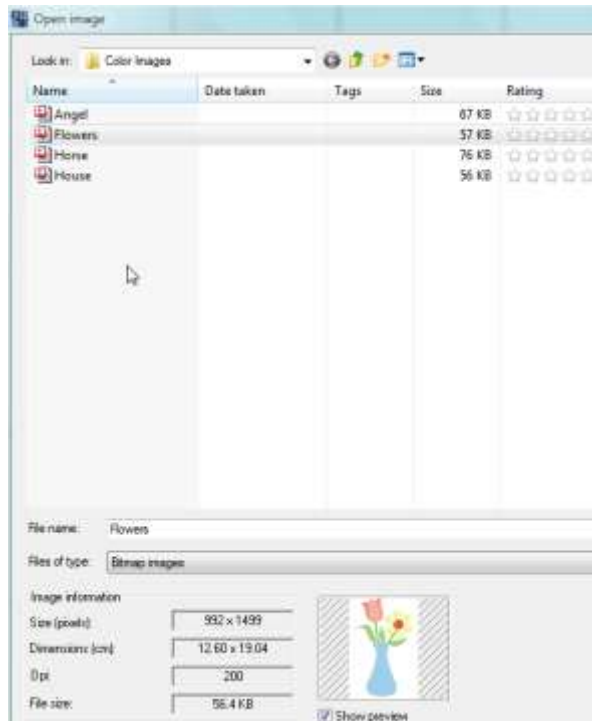

4. In the Image Transformation screen, select Color Image in the Image Type field. Click Next to continue.

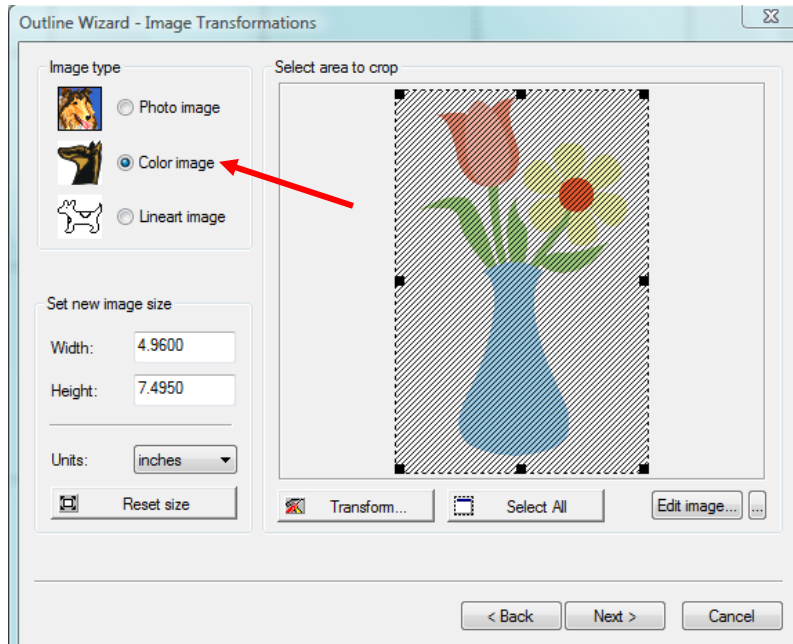

5. In the Vectorize field rely on the default settings and click on Finish. This will send the design to the workspace. The program has assigned a run stitch to the segments.

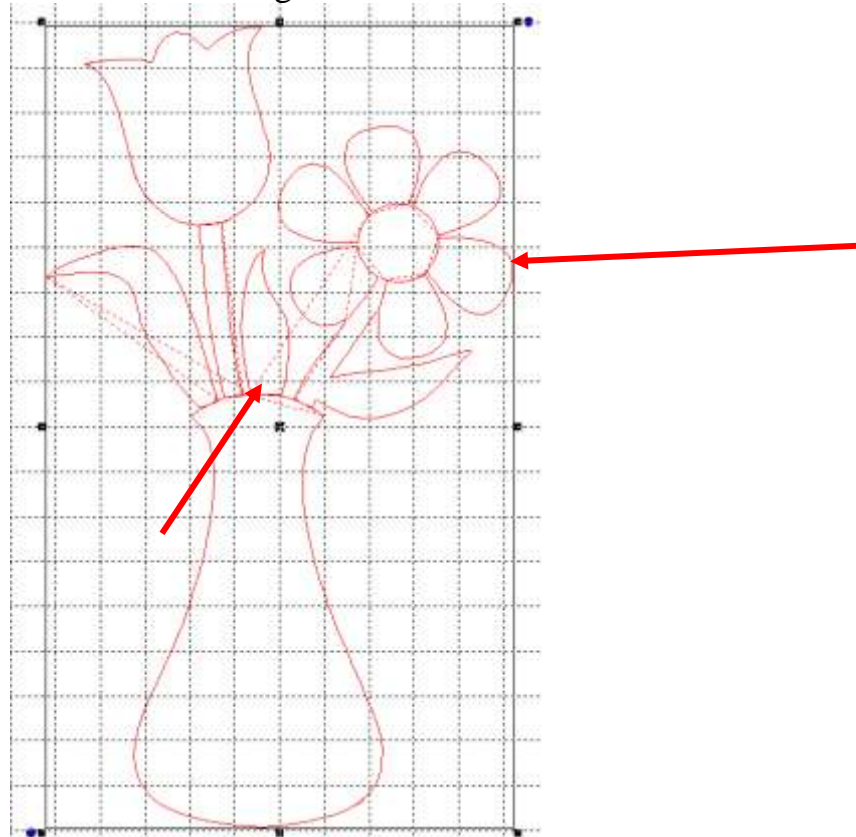

6. We only want a couple of elements from this design: the flower on the right side and the leaf in the middle. To delete, resize and change the type of stitch on the flower follow the next set of steps:

- Under the Sequence View select the first six elements while holding down the Ctrl key.

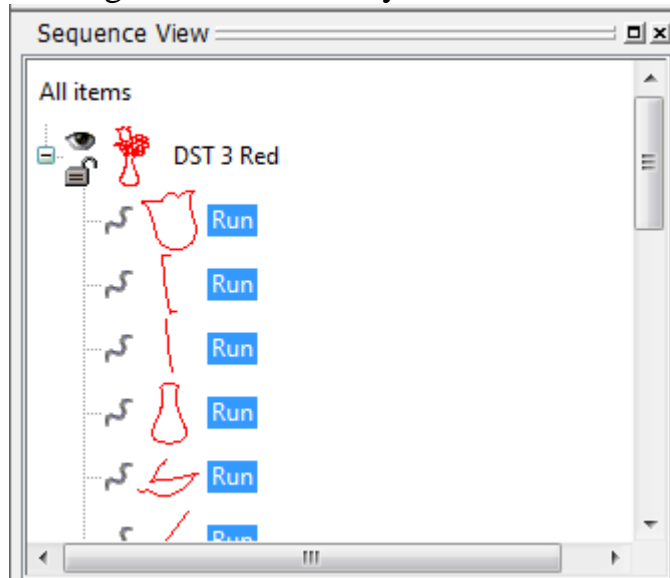

- Tap on the Delete key to remove those areas.
- Scroll down in the Sequence View and select the last two elements and delete them as well.

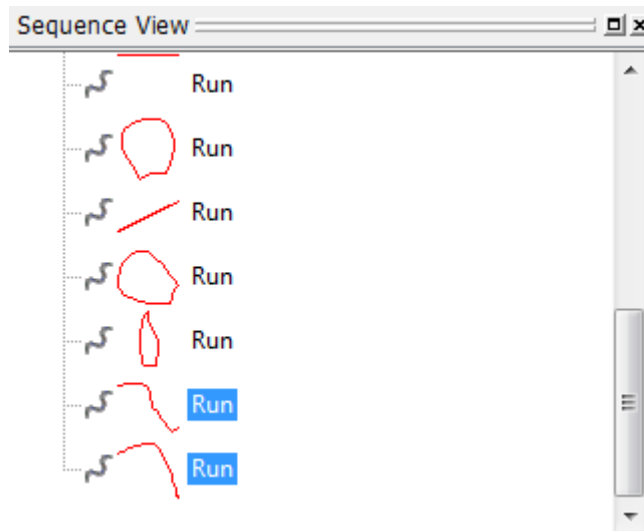

- Select only the flower elements, minus the leaf. Left click while holding down the mouse and draw a box around the flower. This will select only the elements within the drawn box. (See the following illustration.)

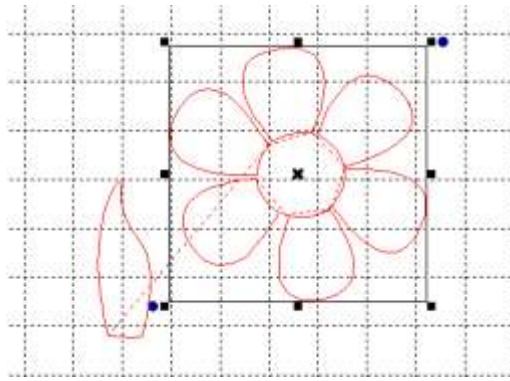

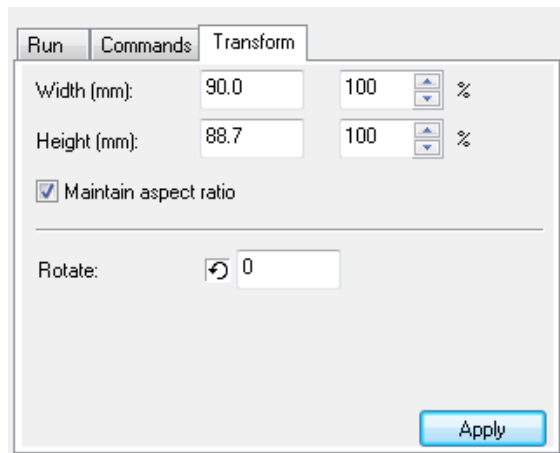

- Right click on the design and from the list of commands select Combine. Notice the change under Sequence View; the elements are grouped together.
- Click on the Transform tab in the Properties field. Change the size in the Width field to 90mm. Click on Apply.

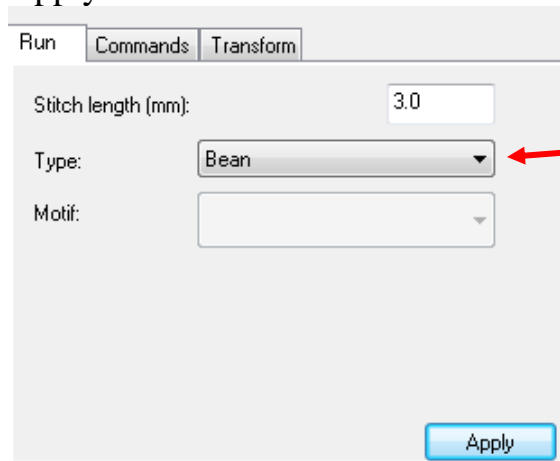

- With the flower still selected, click on the Run tab. Click on the down arrow next to Type and selected the Bean stitch. Click on Apply.



7. To make adjusts to the leaf, follow the next set of directions to resize and change the stitch type:
 - Select the leaf with a left click on the mouse. You can also select it from the Sequence View.

- Under the Properties field select the Transform tab. Change the size to 50mm in the width field. Click on Apply.
 - Click on the Run tab and select the Bean stitch. Click on Apply.
8. Since we will want two separate design files (one for the leaf and another for the flower) we need to separate the two designs. Follow the next set of directions:
 - Select the leaf design only.
 - Right click on the design and select Cut.
 - Click on the New Page  icon.
 - Right click anywhere on the workspace and choose Paste from the commands. This will place the leaf design on the new page.
 9. Click on Print Preview  and follow the prompts to print out three templates of the leaf design.
 10. Click on File Save As and save as a Working File format (.blf) and then save as a .pes file to the media device that your embroidery machine will read.
 11. Click on the page where the flower design is located.
 12. Click on Print Preview  and follow the prompts to print out three templates of the flower design.
 13. Click on File Save As and save as a Working File format (.blf) and then save as a .pes file to the media device that your embroidery machine will read. Set the designs aside for now.

At the Cutting Table:

1. With the seam ripper as your tool, remove the sleeves from the sweater.
2. Cut 3" wide bias strips from the green print fabric.

At the Embroidery and the Sewing Machine:

1. Piece the bias strips together to make one continuous strip. The strip will be sewn around the sleeve openings and around the outer edge of the vest.
2. With raw edges together on the long edge of the bias strip and the wrong sides together, press the bias strip. Set aside.
3. To maintain the shape of the sleeve openings, pin the tape close to the edge and sew in place.
4. With the raw edge of the bias strip even with the right side of the sleeve opening, attach the binding using a 3/8" seam allowance. Start to sew 3" in from the start of the binding. Cut the opposite end 1" longer than the distance around the sleeve opening and tuck inside the starting point of the bias. Sew the binding in place. Fold the bias strip to the inside of the sweater and hand sew the bias to the sweater. Repeat for the other sleeve.

The rest of the bias will be added after the embroidery has been completed.

5. Hoop the tear-away stabilizer and spray with the temporary spray adhesive.
6. Place the flower templates on the front of the vest to determine the placement of the designs. Pin the templates to the vest. In the sample, three flowers were placed on the right side of the sweater and two were placed on the left side.
7. With the placement set, center the first template in the hoop, centering the cross marks on the template with the marks on the hoop.
8. Merged the flower design onto the embroidery machine's workspace, center the needle over the cross marks on the template.
9. Remove the template from the hoop and embroider the design using a thread color that matches the fabric. In the sample, a bright green thread was used.
10. Remove the hoop from the machine and gently remove the stabilizer from the back.
11. Hoop the tear-away stabilizer and spray with the temporary spray adhesive. Place the next template in the hoop and embroider the same design using the same thread color. Repeat this step until all of the flowers have been embroidered.
12. To add the flower stems to the vest, use a Chalko liner, to mark the placement lines for the stems. There will be three stems on the right side and two on the left side.
13. Set the machine up for sewing and select a decorative zig-zag stitch. Using the same thread that was used for the embroidered flowers wind the bobbin and thread the machine. Place a piece of stabilizer on the backside of the vest. Using the Chalko lines as a guide, sew the decorative stitch on the sweater to form the stems. Repeat until all of the stems have been created.
14. To determine the placement of the leaves, place the templates on the sweater. Once placement has been determined, pin the template to the vest.
15. Hoop the tear-away stabilizer and spray with the temporary spray adhesive. Place the first template in the hoop and embroider the leaf design using the same thread color that was used for the flowers and stems. Remove the template before embroidery. Repeat this step until all of the leaves have been embroidered.
16. Starting at the back edge of the collar, place the raw edge of the bias strip to the right side of the vest. Start 3" from the end of the bias strip and use a 3/8" seam allowance to attach the strip. Cut the bias strip 1" longer than the opening and tuck the end inside the starting point of the bias and continue to sew the bias in place.
17. Turn the bias to the inside and hand sew in place.

18.To finish the vest, cover the buttons using the green print fabric.

Before picture:



Your Email Could Use A Little Embroider-E

Subscribe to the only embroider e-news devoted to embroidery software today :>



Designer's Gallery
Lets Embroidery Designs Work For You

For other exciting projects like this one, visit our Web site at www.designersgallerysoftware.com