

“Embroidered Pillow Sham – CustomWorks II”



CustomWorks II from Designer’s Gallery will certainly be the hero after using the built-in Scatter feature to create this pillow sham. You are certain to discover some fun and interesting design placements that will definitely peak your interest.

Skill Level: Intermediate

Created by: Diane Kron, Software and Embroidery Project Manager

Supplies:

Baby Lock® Ellisimo sewing and embroidery machine
CustomWorks II from Designer's Gallery®
Six-print fabrics to coordinate with your quilt top
White fabric for center
Purchased gathered fringe
Baby Lock® Tear-Away stabilizer
Temporary spray adhesive
Water soluble marking pen
Sewing and embroidery thread
General sewing and embroidery supplies

Instructions

At the Computer:

1. Open the program by clicking on the CustomWorks II  icon on the desktop.

2. To retrieve the design, click on Merge Design  icon on the top toolbar while using the Browser to locate the Designer's Gallery folder on the "C" drive. Click on the Plus sign to open CustomWorks (as shown in the following illustration) and place a checkmark next to Carousel Designs.

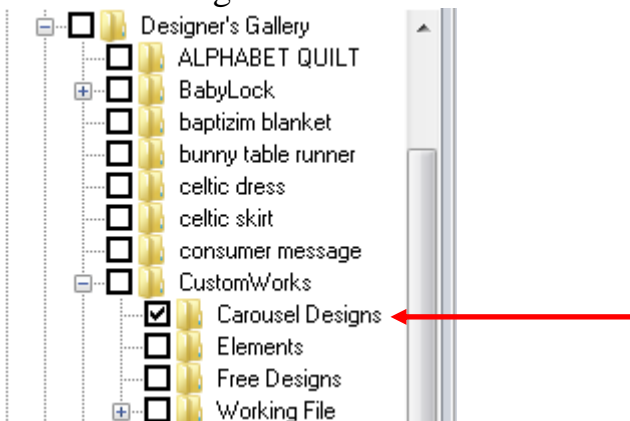

With the designs displayed, scroll down and select jacobean3.blf and click on Open to place the design on the workspace.



jacobean1-3.BLF
66.2mm x 75.0mm
St: 4671, C: 6



jacobean2.BLF
76.8mm x 75.0mm
St: 3932, C: 5

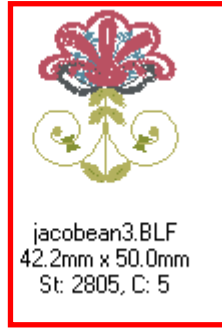

jacobean3.BLF
42.2mm x 50.0mm
St: 2805, C: 5



jacobean4.BLF
72.6mm x 75.0mm
St: 4490, C: 5

100%

- Click on the Zoom dropdown and set the Zoom at 100%. Since the design is a good size, nothing will be done to resize the design at this time. If the colors need to be changed, choose the Color Palette by clicking on the down arrow and choose the color palette that you normally use. In the sample, the Madeira Thread Chest palette was used. Select the first color Under Sequence View and click on the color you wish to use. Repeat to recolor any other areas in the design as desired. If you place a color that does not coordinate with the fabric that was chosen, choose a different color until you are satisfied.
- To place the hoop on the workspace, click on Menu View. From the dropdown click on Select Hoop. Click on 300mm x 200mm hoop for the Ellisimo and click OK.
- With all elements in the design selected, right click on the design. Select Scatter from the list of commands.
- Under the Template Size, set the Width to 300mm.
- Under Design Properties, Set the Max Scale to 125% and the Min Spacing to 7mm. For the remaining settings rely on the default settings.

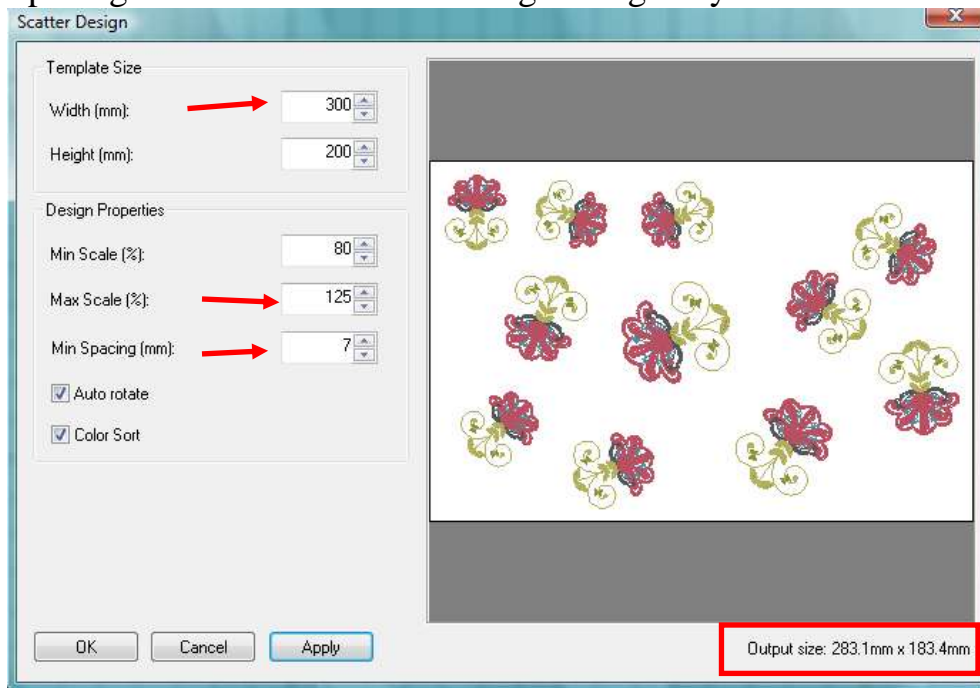

8. Click on Apply. The design will be duplicated and rotated while resizing the designs so that the duplicated designs will fit within the 300mm x 200mm hoop. The size of the complete design layout will be displayed on the bottom right side, under the design window. Continue to click on Apply, until the designs are positioned as desired. There are an undeterminable number of design placement options.
9. After you are satisfied with the placement of the designs, click on OK to send the design to the workspace.
10. If you wish to move any of the designs individually: Select All Items under Sequence View. Right click and from the list of commands select Ungroup. Click on the Select tool and drag a box around all elements in the design to be moved. Move the design as desired. Repeat for any or all of the designs.
11. Click on File Save As and save as a Working File format (.blf). Then, save as a .pes file to the media device that your embroidery machine will read.

At the Cutting Table:

1. From the white fabric, cut one piece that measure 15" x 10". This section will be embroidered.
2. From the assortment of fabric prints, cut 2 ½" wide strips.
3. For the back of the pillow sham cut two pieces from the same fabric that measure 20" x 24".

At the Embroidery Machine:

1. Fold the white center fabric in fourths and press the creases into the fabric. The center of the fabric will be where the two fold lines intersect. Place cross marks in the center with a water soluble marking pen.
2. Hoop the stabilizer and the white fabric in the hoop (300mm x 200mm), while being careful that the cross mark is positioned in the center of the hoop.
3. With the machine on and the design on the machine's workspace, center the needle over the cross mark on the fabric following the manufacturer's directions.
4. Embroider the design.

Assembly:

1. Piece the five strips together using a ¼" seam allowance while rotating the print order. These strips will form the front of the pillow sham.
2. Trim the edges on the white embroidered section. On each side of the embroidered section place one set of strips. Trim the ends as needed.
3. For the top and bottom of the sham, place a long strip across the width of the sham.

4. For the back, hem one edge on both 24" pieces. You may need to trim these sections depending on the size pillow sham you are making.
5. Pin the back to the front section while overlapping the two hemmed back sections. This will form an opening for inserting the pillow. Using a 1/2" seam allowance, sew the front to the back. Trim the corners and turn the sham right side out.
6. Attach the trim approximately 2 1/2" around the outer edge of the sham to form the flange.

For other exciting projects like this one, visit our Web site at www.designersgallerysoftware.com



Your Email Could Use A Little Embroider-E

Subscribe to the only embroider e-news devoted to embroidery software today :)



Designer's Gallery[®]
Lets Embroidery Designs Work For You